

48/32
DRAWING NUMBER

PLAN HOLD CORPORATION • IRVINE, CALIFORNIA
REDESIGNED BY NUMBER 07548

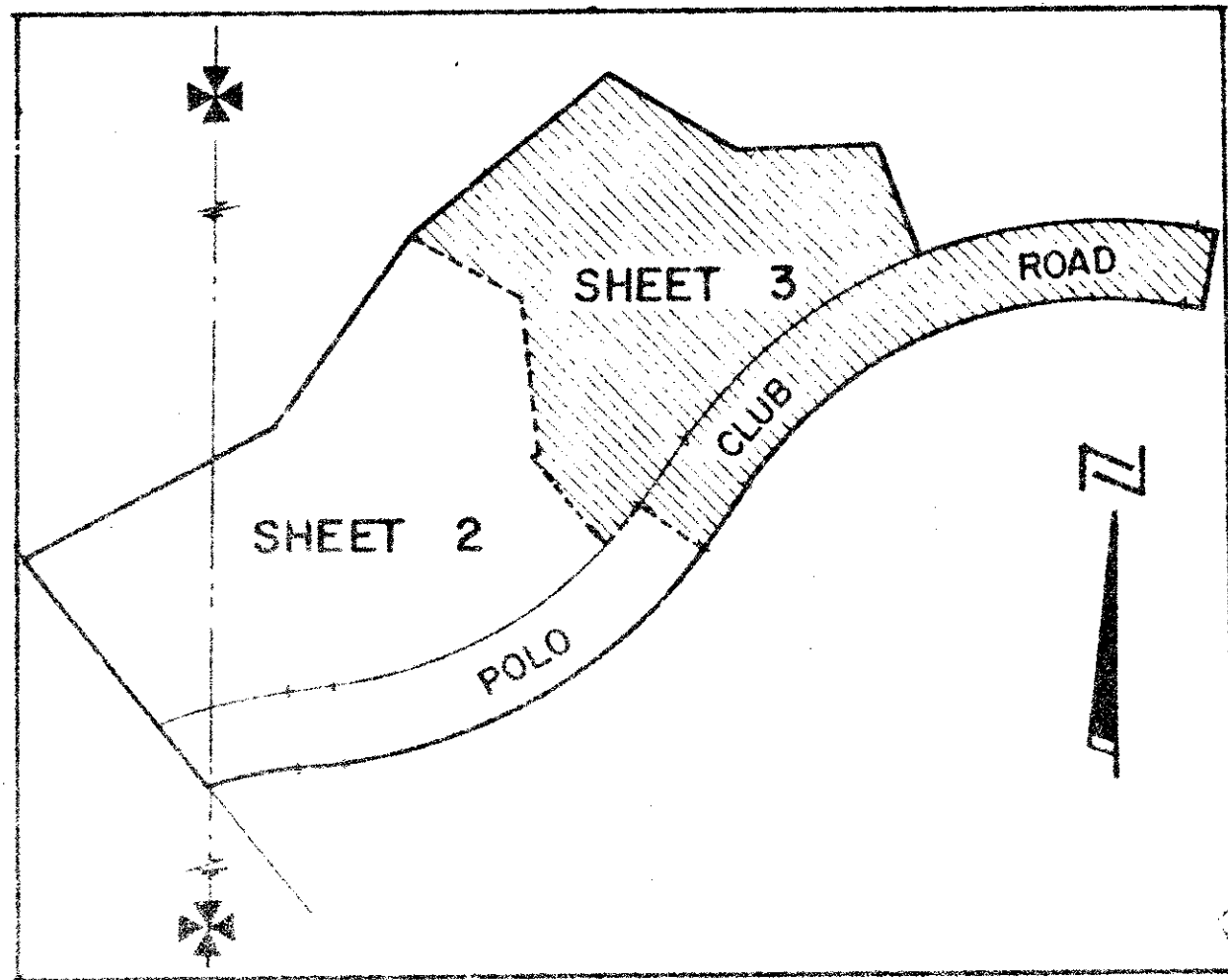

PLAT SHEET INDEX MAP SCALE 1" = 200'

MUIRFIELD - PLAT NO. 1 OF PALM BEACH POLO AND COUNTRY CLUB WELLINGTON - P.U.D.

IN SECTIONS 14 & 15 TWP. 44S., RGE. 41E.

PALM BEACH COUNTY, FLORIDA.

DATE: APRIL 1984

SHEET 3 OF 3 SHEETS

32

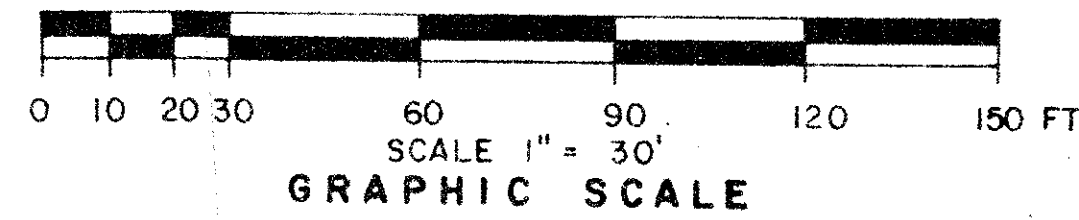
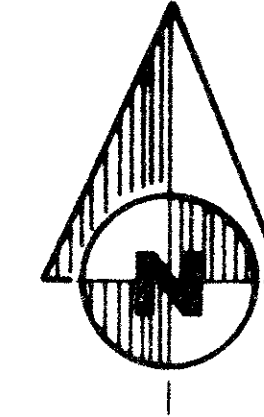

DRAWING NUMBER

PLAN HOLD CORPORATION • IRVINE, CALIFORNIA
REDESIGNED BY NUMBER 07548

DRAWING NUMBER

PLAN HOLD CORPORATION • IRVINE, CALIFORNIA
REDESIGNED BY NUMBER 07548

DRAWING NUMBER

PLAN HOLD CORPORATION • IRVINE, CALIFORNIA
REDESIGNED BY NUMBER 07548



AR
PUD NAME MUIRFIELD PLAT #1 OF PALM BEACH POLO AND COUNTRY CLUB - WELLINGTON - P.B.

NOTES

- ALL BEARINGS SHOWN HEREON ARE RELATIVE TO AN ASSUMED MERIDIAN USED THROUGHOUT WELLINGTON.
- BUILDING SETBACK LINES SHALL BE AS REQUIRED BY PALM BEACH COUNTY ZONING REGULATIONS.
- NO STRUCTURES, TREES OR SHRUBS SHALL BE PLACED ON DRAINAGE EASEMENTS.
- APPROVAL OF LANDSCAPING ON UTILITY EASEMENTS OTHER THAN WATER AND SEWER SHALL BE ONLY WITH THE APPROVAL OF ALL UTILITIES OCCUPYING SAME.
- WHERE DRAINAGE EASEMENTS AND UTILITY EASEMENTS CROSS, DRAINAGE EASEMENTS SHALL TAKE PRECEDENCE.
- DENOTES PERMANENT REFERENCE MONUMENT
- DENOTES PERMANENT CONTROL POINT
- EASEMENTS ARE FOR PUBLIC UTILITIES, UNLESS OTHERWISE NOTED.

THIS INSTRUMENT WAS PREPARED BY
NICK MILLER OF DAILEY-FOTOPNY,
1028 SOUTH MILITARY TRAIL
WEST PALM BEACH, FLORIDA

48/32
MUIRFIELD #1 PBPC

0332-042

 **Dailey-Fotopny, inc.**
land surveyors, planners, engineers
1028 So Military Trail West Palm Beach, Florida 33416 Phone 813 965 8787